

PDB-GILLARD SPOILER+MOUNTINGS+BUMPERS

SPOILERS AND MOUNTINGS - 1

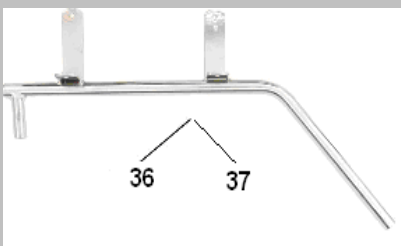
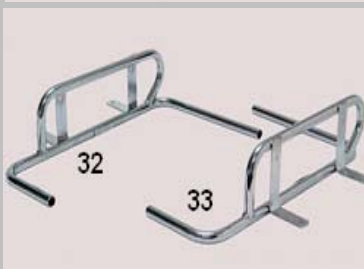
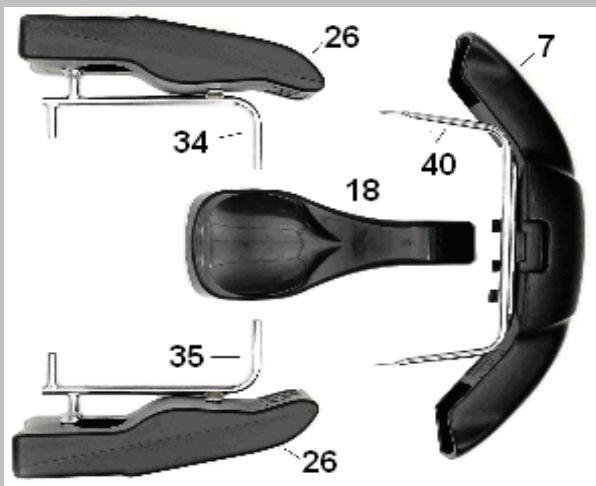

PDB-GILLARD SPOILER+MOUNTINGS+BUMPERS

SPOILERS AND MOUNTINGS - 2		
No.	Article number	Description
1	108,565	Front spoiler MINI-900
2	108,570	Front spoiler 2002 - RAPTOR- MINI SCAN.
3	108,550	Front spoiler KE-03
4	108,540	Front spoiler STILO-EVO
7	108,561	Front spoiler MINI -NEW AGE-
15	108,825	Front fairing STILO-EVO
16	108,820	Front fairing UNICO
17	108,810	Front fairing KE-2002
18	108,817	Front fairing MINI -NEW AGE-
10	108,867	Rear fairing KG GLOB
11	108,868	Rear fairing KG MINI-KART
20	108,640	Side pod STILO-EVO right
21	108,645	Side pod STILO-EVO left
22	108,630	Side pod UNICO
25	108,664	Side pod MINI-900
26	108,660	Side pod MINI -NEW AGE-
30	108,910	Side bar STILO-EVO left
31	108,912	Side bar STILO-EVO right
32	108,900	Side bar UNICO left
33	108,912	Side bar UNICO right
34	108,983	Side bar MINI -NEW AGE- left
35	108,982	Side bar MINI -NEW AGE- right
36	108,981	Side bar MINI-900 left
37	108,980	Side bar MINI-900 right
40	111,300	Front bumper top T-Rex / Charlotte / Daytona
	111,206	Front bumper top MINI - 900
	111,210	Front bumper top MINI -NEW AGE-
	111,200	Front bumper top MINI - Scandinavian
	111,202	Front bumper top MINI - RAPTOR-
42	111,300	Front bumper bottom T-Rex / Charlotte / Daytona

PDB-GILLARD SPOILER+MOUNTINGS+BUMPERS

SPOILERS AND MOUNTINGS - 3

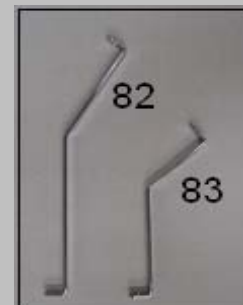
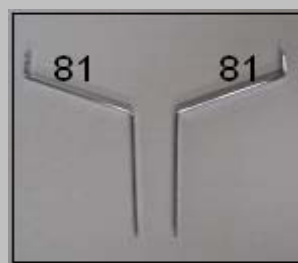
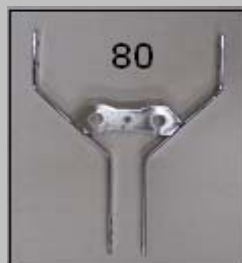
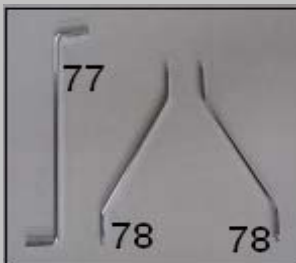
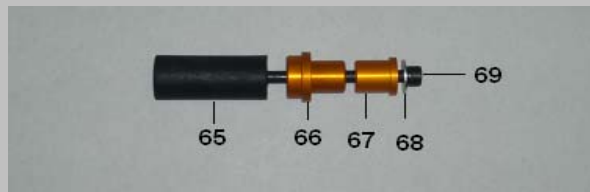
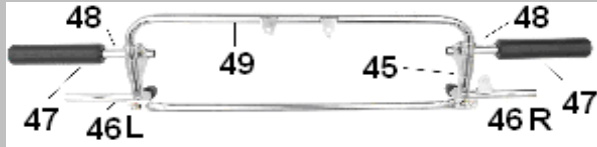
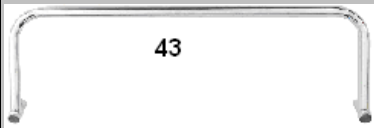

PDB-GILLARD SPOILER+MOUNTINGS+BUMPERS

SPOILERS AND MOUNTINGS - 4		
No.	Article number	Description
43	112,201	Rear bymper MINI-SCAN. / RAPTOR
	112,207	Rear bumper MINI - 900
	112,210	Rear bumper CIK - 2001
44	112,202	Rear bumper MINI-SCAN. / RAPTOR "WIDE"
	112,211	Rear bumper T-REX / Charlotte / Daytona "WIDE"
	112,214	Rear bumper MINI - 900 / ASTERIX"WIDE"
45	112,215	Rear bumper MINI-900 / ASTERIX "ROLLER TYPE"
46R	112,218	Rear bumper connection right -NA-
46L	112,219	Rear bumper connection left -NA-
47	112,216	Rear bumper roller MINI -NEW AGE-
48	112,217	Rear bumper roller support MINI -NEW AGE-
49	112,220	Rear bumper top rail MINI -NEW AGE-
50	108,563	Front spoiler mounting set -ASTERIX-
51	108,592	Front spoilel mounting clamps (2-pc) -ASTERIX-
52	108,594	Front spoiler fixing plate -ASTERIX-
53	108,596	Support front bumper -ASTERIX-
55	108,720	Front spoiler mounting set MINI - 900
56	108,850	Front spoiler mounting set KE-97
58	108,590	Support for front bumper in red
59	108,865	Rear fairing mounting T-Rex / Charlotte / Daytona
60	108,868	Rear fairing mounting MINI
65	142,300	Rear bumper rubber 32mm
	142,290	Rear bumper rubber 30mm
66	142,210	Rear bumper inner sleeve 32mm
	142,215	Rear bumper inner sleeve 32mm for rear fairing
	142,200	Rear bumper inner sleeve 30mm
	142,205	Rear bumper inner sleeve 28mm
67	142,260	Rear bumper outer sleeve
	142,262	Rear bumper outer sleeve for rear fairing
68	900,100	Washer 6X20X1,5 mm
69	900,271	Allen screw 8x120mm
70	142,288	Rear bumper rubber 28mm
71	142,203	Rear bumper inner sleeve 28mm >MINI-ASTERIX<
72	142,253	Outer sleeve -roller type- >MINI-ASTERIX<
	142,252	Outer sleeve -New Age- >MINI-ASTERIX<
73		O-Ring 10mm
74	900,008	Washer 8mm
75	900,277	Allen screw 8x160mm >MINI-ASTERIX<
77	108,207	Bottom front fairing support MINI-NEW AGE
78	108,213	Front fairing top support MINI-NEW AGE
80	108,212	Front fairing top support MINI "old type"
81	108,220	Front fairing top support
82	108,200	Front fairing bottom support
83	108,201	Front fairing bottom support MINI-SCAN / RAPTOR

PDB-GILLARD STICKER SETS

STICKER SET STILO-EVO - 6

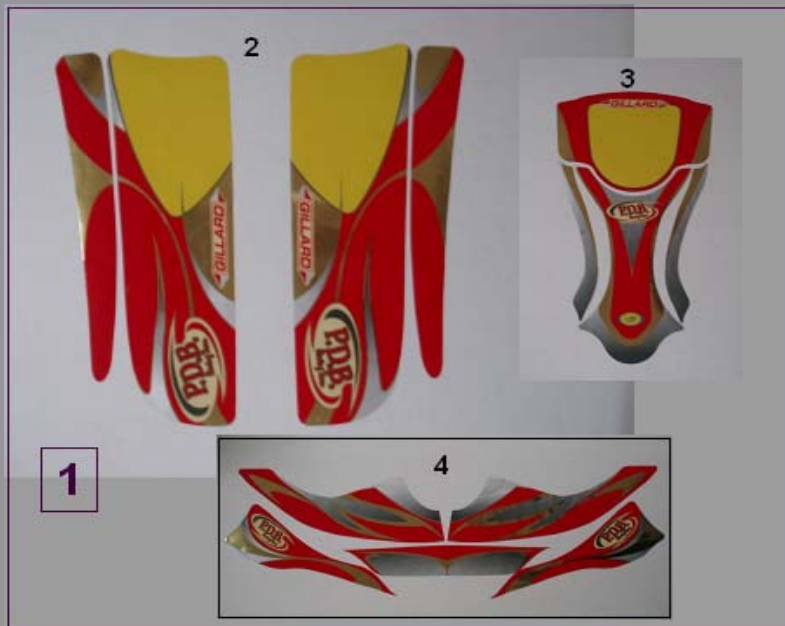

No.	Article number	Description
1	100,303	Sticker set complete Stilo-Evo >PDB 2009<
4	100,304	Sticker front spoiler Stilo-Evo >PDB 2009<
5	100,317	Sticker for tank complete Stilo-Evo >PDB 2009<

STICKER SET UNICO



No.	Article number	Description
1	100,305	Sticker set complete Unico >PDB 2006<
4	100,310	Sticker front spoiler Unico >PDB 2006<
5	100,311	Sticker for tank complete Unico >PDB 2006<

PDB-GILLARD STICKER SETS

STICKER SET MINI NEW-AGE - 7



No.	Article number	Description
1	100,307	Sticker set complete MINI-PDB New-Age
4	100,308	Sticker front spoiler MINI-PDB New-Age

STICKER CHAIN GUARD



No.	Article number	Description
1	100,312	Sticker PDB-2006 for chain guard Tillett
2	100,316	Sticker PDB-2009 for chain guard Tillett

PDB-GILLARD REAR AXLES



No.	Article number	Description
1	147,952	Rear axle 50x2x1040 -orange- "extra soft"
	147,956	Rear axle 50x2x1040 -red- "soft"
	147,960	Rear axle 50x2x1040 -brown- "medium soft"
	147,975	Rear axle 50x2x1040 - gold-
	147,963	Rear axle 50x2x1040 -green- "medium" - standard
	147,966	Rear axle 50x2x1040 -white- "medium hard"
	147,969	Rear axle 50x2x1040 -blue- "hard"
	147,953	Rear axle 50x2x1000 -orange- "extra soft"
	147,958	Rear axle 50x2x1000 -red- "soft"
	147,961	Rear axle 50x2x1000 -brown- "medium soft"
	147,976	Rear axle 50x2x1000 - gold-
	147,965	Rear axle 50x2x1000 -green- "medium" - standard
	147,967	Rear axle 50x2x1000 -white- "medium hard"
	147,970	Rear axle 50x2x1000 -blue- "hard"
	147,984	Rear axle 50x2x1040 -S- "extra soft"
	147,987	Rear axle 50x2x1040 -B- "soft"
	147,985	Rear axle 50x2x1040 -D- "medium soft"
	147,986	Rear axle 50x2x1040 -F- "medium"
	147,988	Rear axle 50x2x1040 -M- "medium hard"
	147,989	Rear axle 50x2x1040 -K- "hard"
147,990	Rear axle 50x2x1000 -B- "soft"	
147,991	Rear axle 50x2x1000 -D- "medium soft"	
147,992	Rear axle 50x2x1000 -F- "medium"	
147,993	Rear axle 50x2x1000 -M- "medium hard"	
147,994	Rear axle 50x2x1000 -K- "hard"	
2	147,420	Rear axle 40x3x930 -orange- "extra soft"
	147,421	Rear axle 40x3x930 -red- "soft"
	147,430	Rear axle 40x1040-V -red- "soft"
	147,431	Rear axle 40x1040-V -brown- "medium soft"
	147,432	Rear axle 40x1040-V -green- "mediumt"
	147,433	Rear axle 40x1040-V -white- "mediumt"
	147,450	Rear axle 40x3x1040-B -blue- "soft"
	147,453	Rear axle 40x3x1040-F -yellow- "medium"
	147,456	Rear axle 40x3x1040-M -red- "medium hard"
147,459	Rear axle 40x3x1040-K -green- "hard"	
3	147,593	Rear axle 30x2x900
	147,595	Rear axle 30x5x900
4	147,402	Rear axle 25mm

PDB-GILLARD MASTER BRAKE CALIPER

MASTER CALIPER 2006-2009 (10)

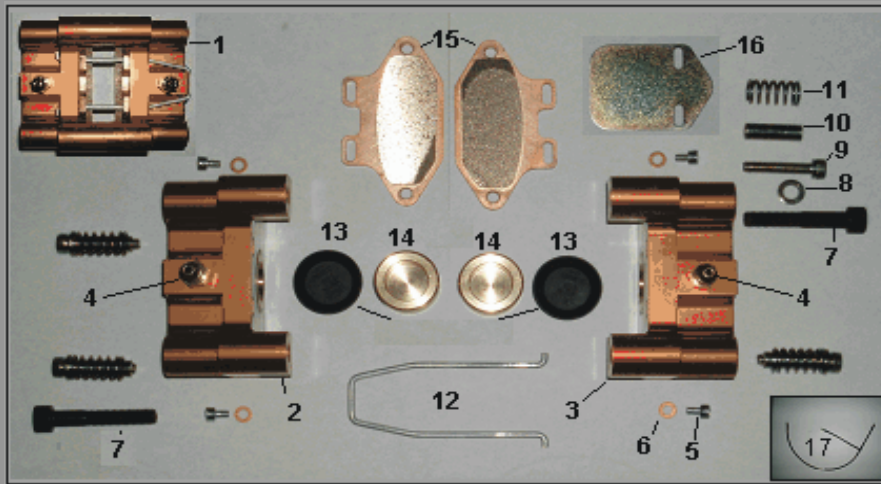

MASTER CALIPER 2003

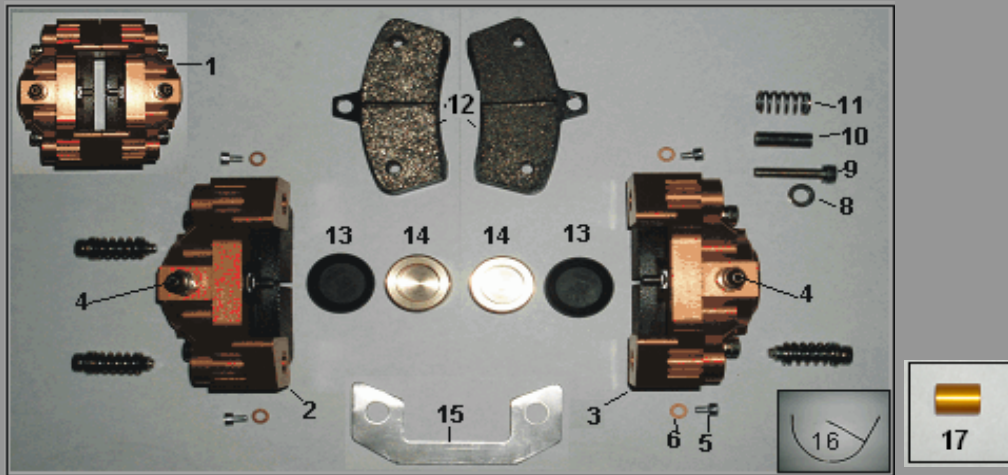

PDB-GILLARD FRONT BRAKE SYSTEM -FBS-

FRONT BRAKE SYSTEM - FBS (13)

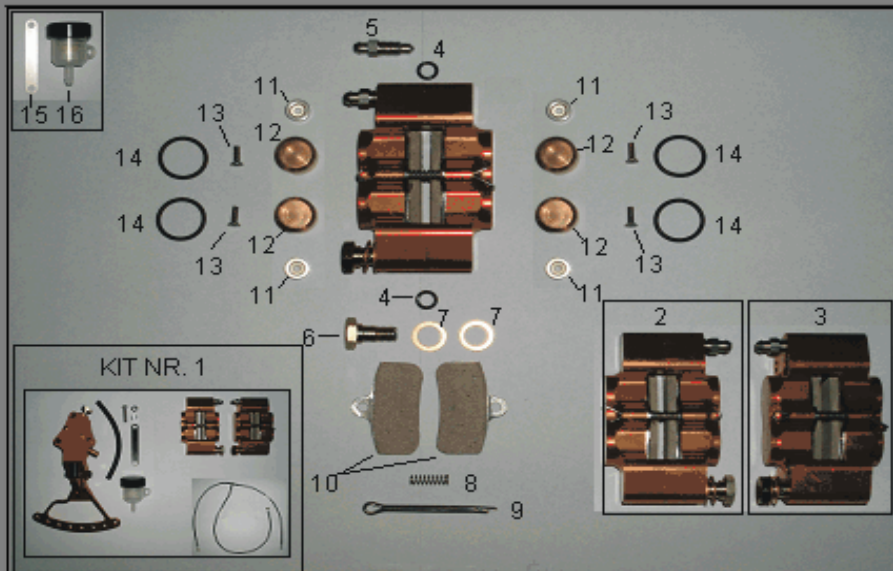

1

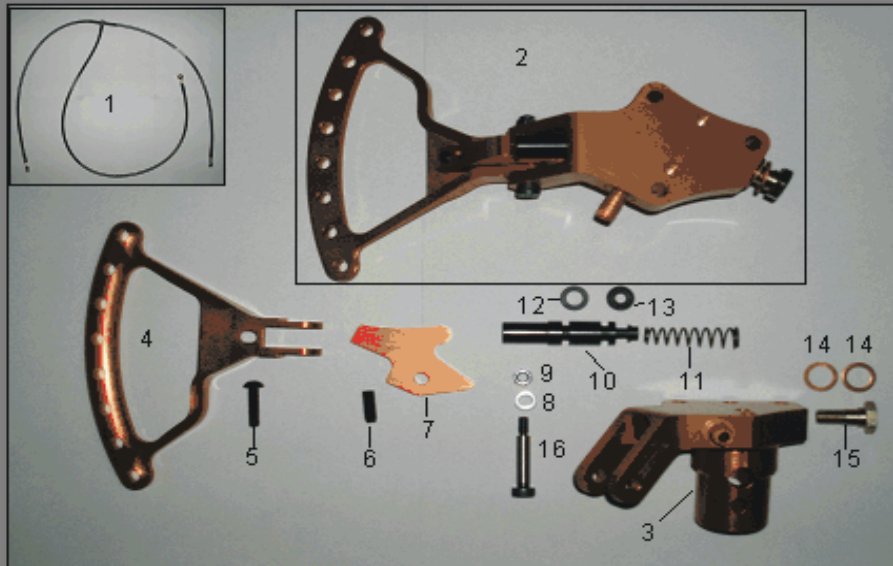

PDB-GILLARD BRAKE CALIPERS TR-05

REAR AND FRONT BRAKE CALIPER TR-05 (15)

REAR TR-05

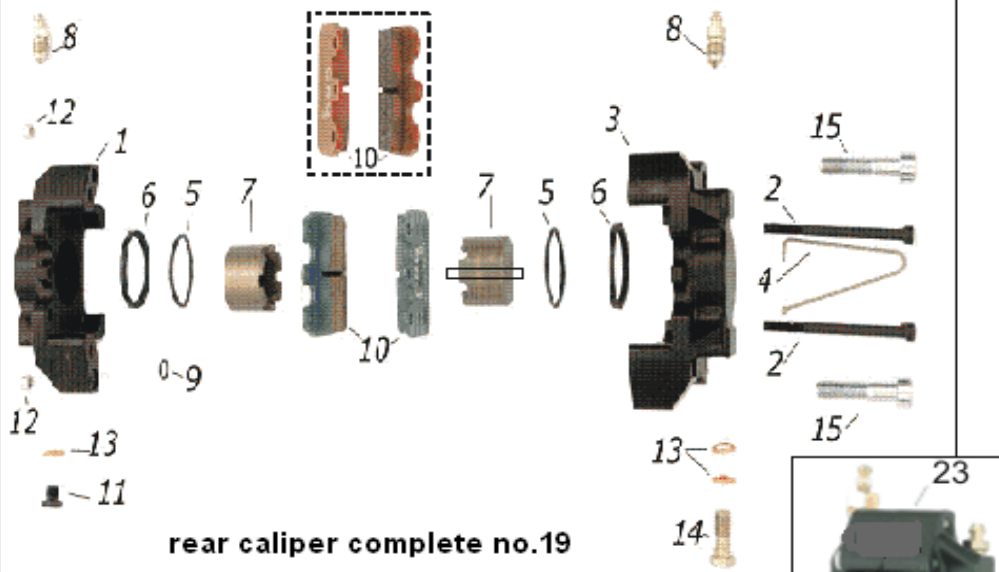

FRONT TR-05

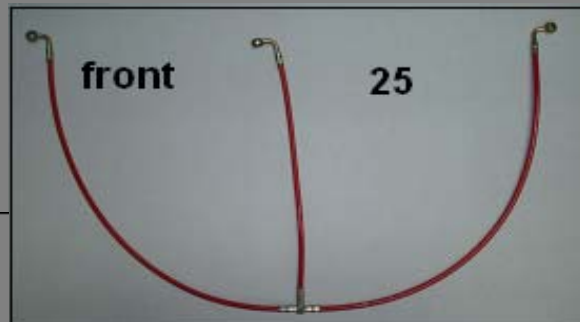
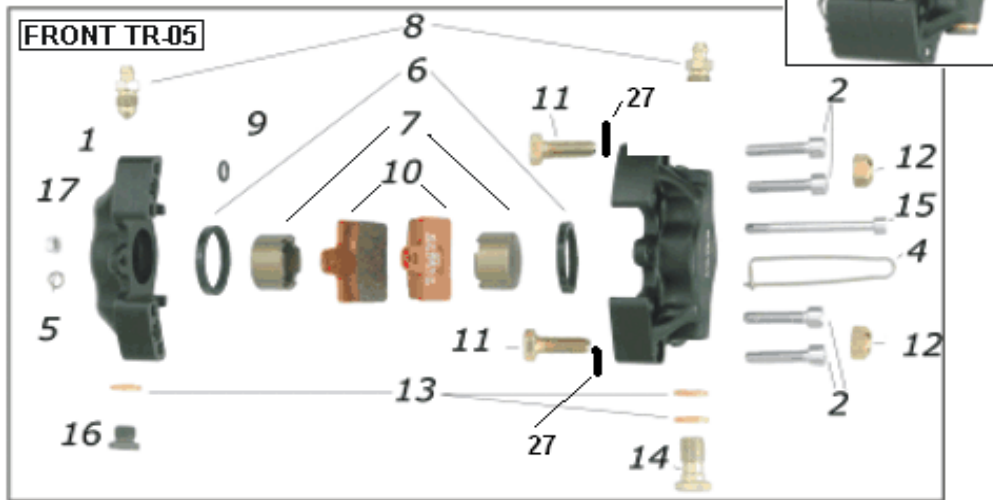

PDB-GILLARD BRAKE CALIPERS TR-05

REAR BRAKE CALIPER TR-05 (16)		
No.	Article number	Description
2	150,547	Hexagon bolt m5x80
3		
4	150,575	Spring locker for brake pad
5	150,548	Rear caliper dust guard seal
6	150,549	Rubber seal for master caliper
7	150,586	rear brake caliper brass piston
8	150,580	Screw for air bleeding
9	150,542	Master caliper O-R
10	141,300	Brake pad set "soft" set 2-pcs.
	141,301	Brake pad set "medium" set 2-pcs.
	141,303	Brake pad set "DURAL" green set 2-pcs.
11	150,550	Rear brake caliper cap M10 UP black
12	901,103	Nut nyloc m5
13	150,568	Brass washer 14x10x2mm
14	150,565	Bolt 10x1mm for brake pipe
15	900,256	Allen screw 8x45mm
19	150,544	Master caliper complete
20	150,592	Steel support for rear brake caliper
22	150,625	Spacer 16mm for steel support
25	150,579	Rear brake pipe
FRONT BRAKE CALIPER TR-05		
No.	Article number	Description
1		
2	900,237	Allen screw 6x40mm
3		
4	150,575	Spring locker for brake pad
5	150,573	Elastic pin for bolt 5x55mm
6	150,587	Master caliper rubber seal TR05 / MINI
7	150,585	Master caliper brass piston
8	150,580	Screw for air bleeding
9	150,542	Master caliper O-R
10	141,400	Brake pad set "soft" 115-red set 2-pcs.
	141,401	Brake pad set "medium" 222-black set 2-pcs.
11	900,634	Hexagon bolt 8x23
12	901,106	locking nut m8
13	150,568	Brass washer 14x10x2mm
14	150,565	Bolt 10x1mm for brake pipe
15	900,222	Allen screw 5x55mm
16	150,550	Brake caliper cap M10 UP black
17	901,103	Nut nyloc m5
23	173,787	Front brake caliper -right- complete
	173,788	Front brake caliper -left- complete
25	150,578	Front brake pipe
26	179,250	Locking for brake pipe 8mm red
27	150,539	locking ring for front brake caliper

PDB-GILLARD BRAKE CALIPERS TR-04

REAR AND FRONT BRAKE CALIPER TR-04 (17)

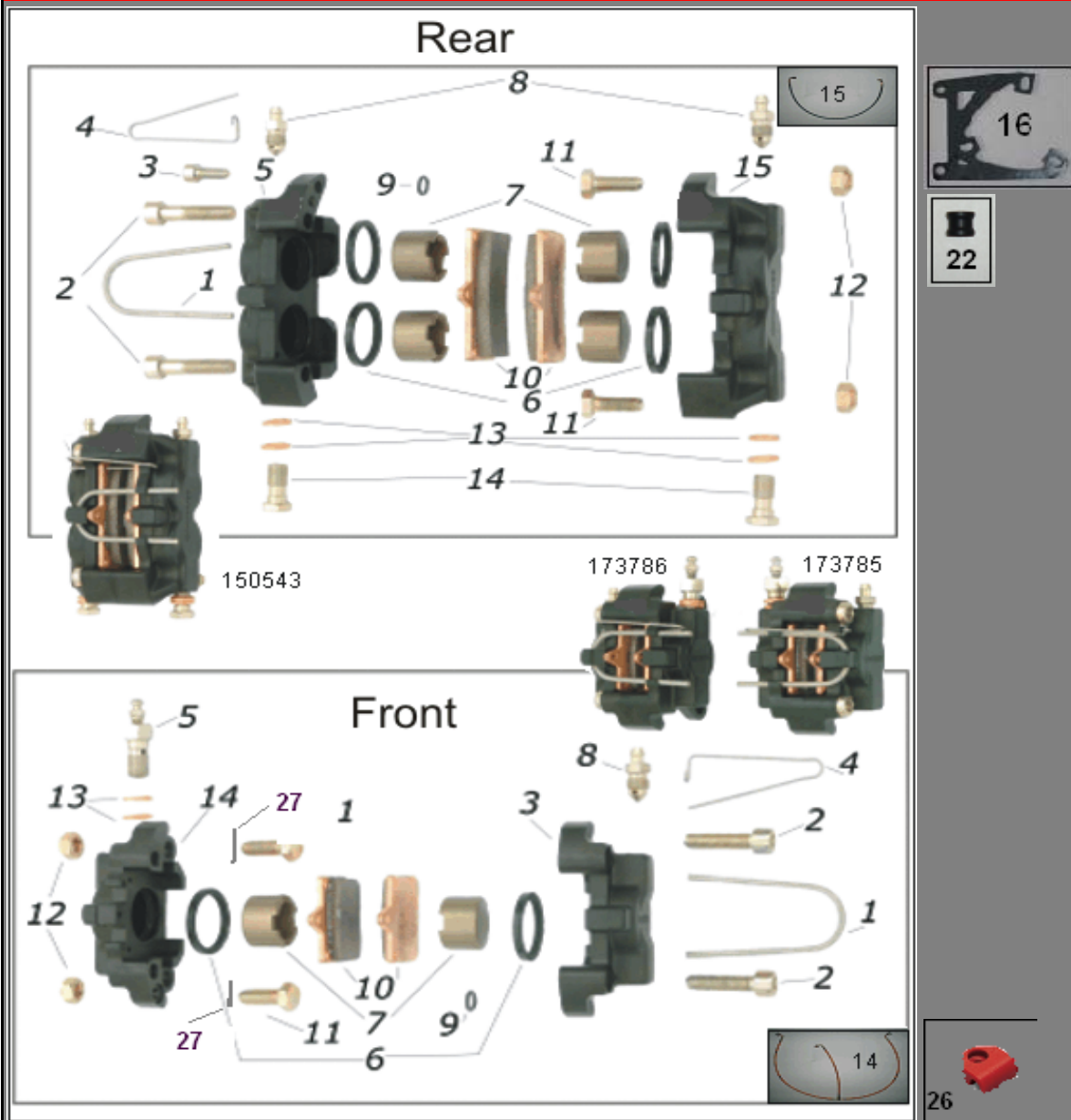

PDB-GILLARD BRAKE CALIPERS TR-04

REAR BRAKE CALIPER TR-04 (18)		
No.	Article number	Description
	150,543	Rear brake caliper complete
1	150,572	Brake pad block pin
2	900,254	Allen screw 8x35mm
3	900,231	Allen screw 6x16mm
4	150,575	Spring locker for brake pad
5		
6	150,587	Rubber seal for master caliper
7	150,581	Rear brake caliper brass piston
8	150,580	Screw for air bleeding
9	150,542	Master caliper O-R
10	141,320	Rear brake pad "soft" set 2-pc
	141,321	Rear brake pad "sinter" set 2-pc
	141,322	Rear brake pad "medium" set 2-pc
11	900,635	Bolt 8x20mm
12	901,107	Nut nyloc m8
13	150,568	Brass washer 14x10x2mm
14	150,565	Bolt 10x1mm for brake pipe
15	150,579	Brake pipe rear complete
16	150,588	Steel support for rear brake caliper
22	150,625	Spacer 16mm for steel support
FRONT BRAKE CALIPER TR-04		
No.	Article number	Description
1	150,572	Brake pad lock pin
2	900,253	Allen screw 8x30mm
3		
4	150,575	Spring locker for brake pad
5	150,566	Bolt 10x1mm for bleeding screw
6	150,587	Master caliper rubber seal
7	150,585	Master caliper brass piston
8	150,580	Screw for air bleeding
9	150,542	Master caliper O-R
10	141,325	Brake pad "soft" set 4-pcs
	141,326	Brake pad "sinter" set 4-pcs.
	141,327	Brake pad "medium" set 4-pcs.
11	900,635	Hexagon bolt 8x20
12	901,106	locking nut m8
13	150,568	Brass washer 14x10x2mm
14	150,578	Brake pipe front complete
	173,785	Front brake caliper right complete
	173,786	Front brake caliper left complete
26	179,250	locking for brake pipe 8mm red
27	150,539	locking ring 8mm for front brake caliper

PDB-GILLARD MASTER CYLINDER TR04 / TR05 / MINI

MASTER CYLINDER TR04 / TR05 / MINI-900 / ASTERIX (21)

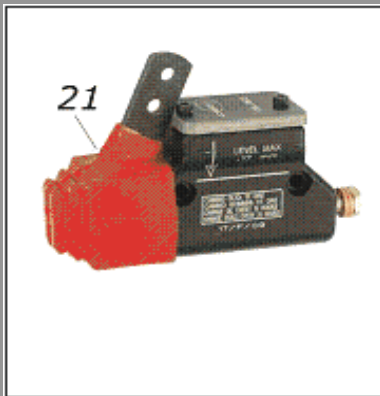
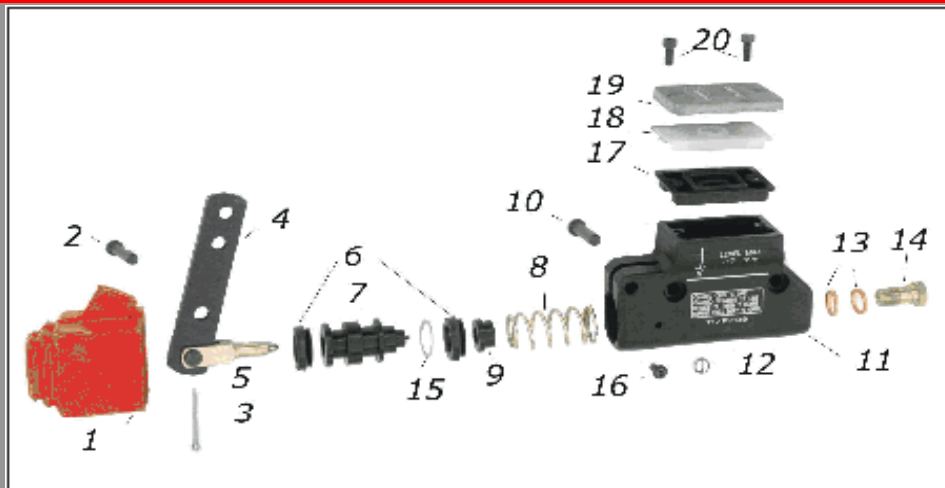

PDB-GILLARD BRAKE DISCS

BRAKE DISCS (23)

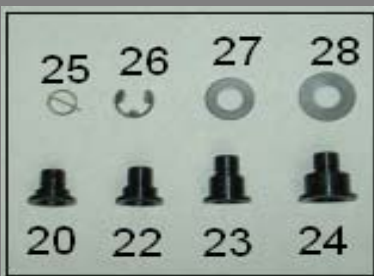
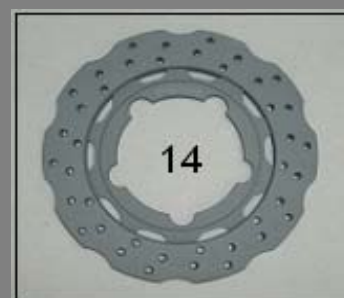

PDB-GILLARD STUB AXLE+EXCENTERS+SPACERS



STUB AXLE 8mm		
No.	Article number	Description
30	169.200	Stub axle left MINI-SCAN / RAPTOR (03.103)
	169.205	Stub axle left MINI 900 / ASTERIX
	169.253	Stub axle left CHARLOTTE 8x17mm (03.141)
	169.259	Stub axle left CHARL. TR-04 / FBS 8x17mm (03.181)
	169.261	Stub axle left CHARL. TR-05 8x17mm (03.185)
31	168.200	Stub axle right MINI-SCAN / RAPTOR (03.108)
	168.205	Stub axle right MINI 900 / ASTERIX
	168.253	Stub axle right CHARLOTTE 8x17mm (03.146)
	168.259	Stub axle right CHARL. TR-04 / FBS 8x17mm (03.191)
	168.261	Stub axle right CHARL. TR-05 8x17mm (03.195)
32	169.880	Stub axle left CHARLOTTE 8x20mm (03.144)
	169.263	Stub axle left CHARL. TR-05 8x20mm (03.186)
	169.885	Stub axle left CHARL. TR-04 / FBS 8x20mm (03.182)
33	168.880	Stub axle right CHARLOTTE 8x20mm (03.149)
	168.263	Stub axle right CHARL. TR-05 8x20mm (03.196)
	168.885	Stub axle right CHARL. TR-04 / FBS 8x20mm (03.192)
34	169.920	Stub axle left CHARLOTTE 8x25mm (03.145)
	169.915	Stub axle left CHARL. TR-04 / FBS 8x25mm (03.183)
	169.917	Stub axle left CHARL. TR-05 8x25mm (03.187)
35	168.920	Stub axle right CHARLOTTE 8x25mm (03.150)
	168.915	Stub axle right CHARL. TR-04 / FBS 8x25mm (03.193)
	168.917	Stub axle right CHARL. TR-05 8x25mm (03.197)

PDB-GILLARD WHEELS

WHEELS MINI (28)



No.	Article number	Description
1	174,050	Front wheel alum. 115mm without bearings
2	154,112	Rear wheel 140mm
4	174,852	Front wheel magn. HQ - DR - 130mm
5	154,855	Rear wheel HQ - 150mm
	154,500	Set wheels alum. 115 / 140mm 17-17
	154,502	Set wheels alum. 115 / 180mm 17-17
	154,615	Set wheels free-line CH115-DH150

WHEELS FREE-LINE + PDB

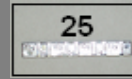
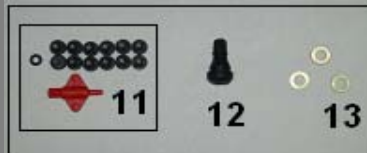

No.	Article number	Description
1	174,820	Front wheel alum. DH - 130mm
2	154,790	Rear wheel alum. DH - 180mm
3	154,800	Rear wheel alum. DH - 210mm
5	174,852	Front wheel magn. HQ - DR - 130mm
6	154,840	Rear wheel magn. HQ - DR - 180mm
7	154,850	Rear wheel magn. HQ - DR - 210mm
8	174,500	Front wheel -PDB- magn. 130mm
9	154,460	Rear wheel -PDB- magnesium "high grip"
	154,459	Rear wheel -PDB- magnesium "low grip"
11	154,995	Safety screw set 12 pcs. complete
12	188,000	Tubeless valve
13	154,998	Washer for wheels 8x15x3mm
14	578,300	Valve + safety screw key Free-line
	154,650	Set wheels Free-line HQ CR130-DH210
	154,652	Set wheels Free-line HQ DR130-DR210
	154,655	Set wheels Free-line HQ DR130-DR180
	154,699	Set wheels Free-line alum. DH130-DH210
	154,670	Set wheels Free-line alum. DH130-DH180

PDB-GILLARD FRONT AND REAR HUBS

FRONT AND REAR HUBS (29)

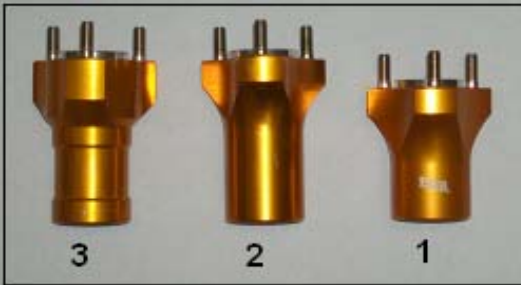

PDB-GILLARD SPROCKET AND BRAKE DISC CARRIERS

SPROCKET CARRIERS (31)



No.	Article number	Description
1	145,114	Sprocket carrier 25mm
2	145,109	Sprocket carrier 30mm
3	145,100	Sprocket carrier 40mm
4	145,121	Sprcoket carrier 50mm
5	145,125	Sprocket carrier 50mm "Magnesium"

BRAKE DISC CARRIERS



No.	Article number	Description
1	149,780	Brake disc carrier 25mm
2	149,110	Brake disc carrier 30mm
3	149,100	Brake disc carrier 40mm
4	149,108	Brake disc carrier 50mm
5	149,109	Brake disc carrier 50mm "Magnesium"

BRAKE DISC CARRIERS MINI + TR05



No.	Article number	Description
1	149,790	Brake disc carrier 25mm -hydraulic-
2	149,792	Brake disc carrier 30mm -hydraulic-
3	149,105	Brake disc carrier 40mm TR05-DD2
4	149,103	Brake disc carrier 50mm TR05

PDB-GILLARD STEERING COLUMN AND TRACK ROD

STEERING COLUMNS AND TRACK RODS (32)

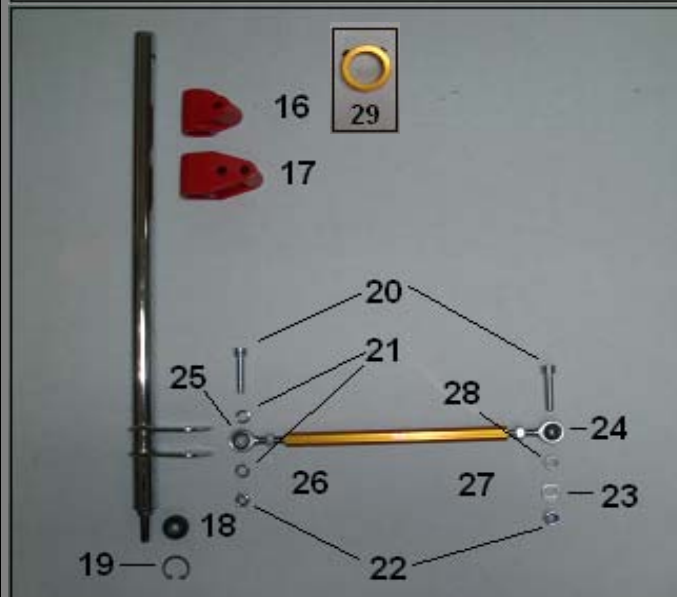

PDB-GILLARD PEDALS-CABLES-CLAMBS GROUP

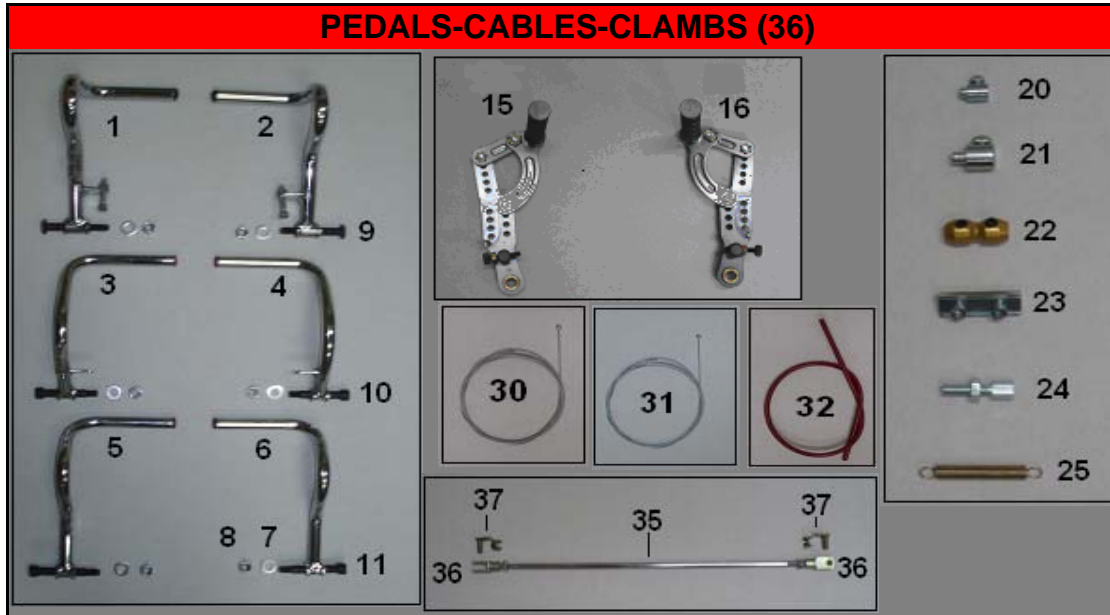

No.	Article number	Description
1	114,202	Brake pedal MINI 900 / Asterix
2	113,202	Accelerator pedal MINI 900 / Asterix
3	113,210	Brake pedal MINI Scan. / Raptor
4	114,201	Accelerator pedal MINI Scan. / Raptor
5	114,220	Brake pedal T-Rex / Charlotte / Daytona (2006-2009)
6	113,220	Accelerator pedal T-Rex / Charlotte / Daytona (06-09)
7	900,004	Washer 8mm
8	901,107	Locking nut 8mm
9	114,852	Pedal bolt MINI 900 / Asterix
10	114,850	Pedal bolt MINI Scan. / Raptor
11	114,851	Pedal bolt T-Rex / Charlotte / Daytona (06-09)
15	114,255	Brake pedal adjustable in aluminium
16	113,255	Accelerator pedal adjustable in aluminium
20	135,050	Cable clamb with side screw 3mm
21	135,060	Cable clamb with side screw 4.5mm
22	135,210	Cable clamb aluminium with 2 screws
23	135,205	Cable clamb with 2 screws
24	136,010	Cable adjust screw 6m
25	176,010	Pedal spring
30	135,010	Accelerator cable for Dell-Orto
	135,000	Accelerator cable 2000x1,2
31	138,600	Brake / clutch inner cable
32	134,030	Outer cable
35	178,694	Brake rod 355mm
	178,693	Brake rod 370mm
	178,695	Brake rod MINI / ASTERIX
36	178,696	Clevis 6mm for brake rod
37	178,697	Brake rod clevis spring

PDB-GILLARD NUMBER PLATE

NUMBER PLATE + NUMBERS (45)

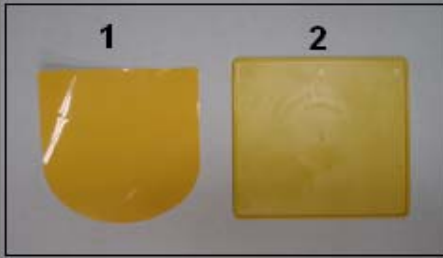

No.	Article number	Description
1	129,500	Number plate sticker in all colours
2	129,000	Number plate in all colours
4	490,000	Number in black on transp.
5	490,000	Number in black on yellow
6	490,000	Number in white on transp.

NUMBER PLATE

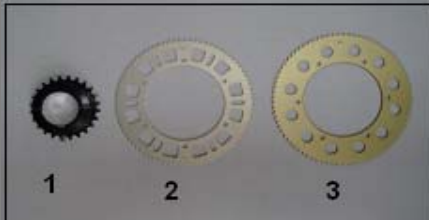

No.	Article number	Description
1	143,090	Sprocket gearbox in "ergal" T- 22 / T- 30
2	143,100	Sprocket "NKP" T- 66 / T- 91
3	143,000	Sprocket T- 66 / T- 91
5	565,805	Chain RK - gearbox 60-L + chain link
	560,810	Chain link RH - gearbox
6	567,846	Chain RK-GB219HR-96
	567,848	Chain RK-GB219HR-98
	567,850	Chain RK-GB219HR-100
	567,851	Chain RK-GB219HR-102
	567,852	Chain RK-GB219HR-104
	567,853	Chain RK-GB219HR-106
	567,854	Chain RK-GB219HR-108
	567,855	Chain RK-GB219HR-110
	567,856	Chain RK-GB219HR-112
	567,857	Chain RK-GB219HR-114
7	567,800	Chain RK-BBKRO-100
	567,801	Chain RK-BBKRO-102
	567,802	Chain RK-BBKRO-104
	567,803	Chain RK-BBKRO-106
	567,804	Chain RK-BBKRO-108
	567,805	Chain RK-BBKRO-110
	567,806	Chain RK-BBKRO-112
	567,807	Chain RK-BBKRO-114

PDB-GILLARD TOOLS AND ACCESSORIES

TOOLS (46)

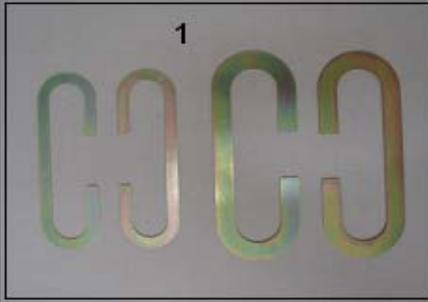

No.	Article number	Description
1	570,750	Set hooks to check frame (4-pcs)

ACCESSORIES

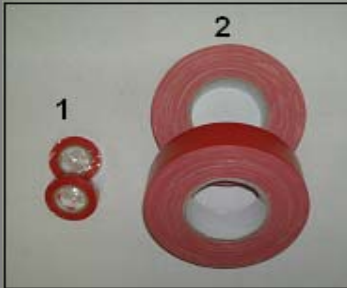

No.	Article number	Description
1	750,020	Tape 15mm rood
2	750,010	Tanktape rood
3	575,000	Silikon 250 special gasket kit
4	575,100	Loctite sealing - blue-

PDB-GILLARD XERAMIC GROUP

XERAMIC GROUP (47)



No.	Article number	Description
1	550,575	Xeramic helmet interior cleaner
2	550,576	Xeramic hlemet visor cleaner
3	550,574	Xeramic carburettor cleaner
4	550,570	Xeramic silocon spray
5	550,550	Xeramic brake cleaner
6	550,515	Xeramic WHITE chain lube
10	550,578	Xeramic brake fluid DOT 4
11	550,510	Xeramic Castor oil 1 ltr.
14	550,560	Xeramic multi-spray
15	550,589	Petromark copper paste
17	550,579	Xeramic instant gasket RED 200 ml.
18	550,580	Xeramic instant gasket BLACK 200 ml.
19	550,571	Xeramic KF gear oil 100 ml.
	550,572	Xeramic KZ transmission oil 1 ltr.
	550,557	Xeramic hand cleaner yellow 600 ml.

PDB-CLOTHES AND BAGS

PDB - CLOTHES AND BAGS (49-50)



